

	1 HOUR FIRE RATED PLASTERBOARD PARTITION WALL 2 LAYERS OF 12.5mm PLASTERBOARD EACH SIDE OF 70MM METAL STUD AT 600mm CENTRE AND 50mm ACOUSTIC ROLL IN THE CAVITY
	PARTITION WALL TO BE DEMOLISHED
	REMOVE SINK AND CLOSE CONNECTION
	REMOVE EXISTING DOOR AND FRAME
	NEW SINK TO BE INSTALLED
	AMEND EXISTING DOOR AND FRAME
	NEW FLOOR FINISH - SEE ROOM SCHEDULE
	REMOVE RAISED FLOOR TO ENGINEERS DETAIL AND INSTALL NEW FLOOR FINISH TO MATCH

PROPOSED CHANGES TO FEBRUARY 2012 SET:
- CHANGE OF PROPOSED USE FOR INDICATED ROOMS

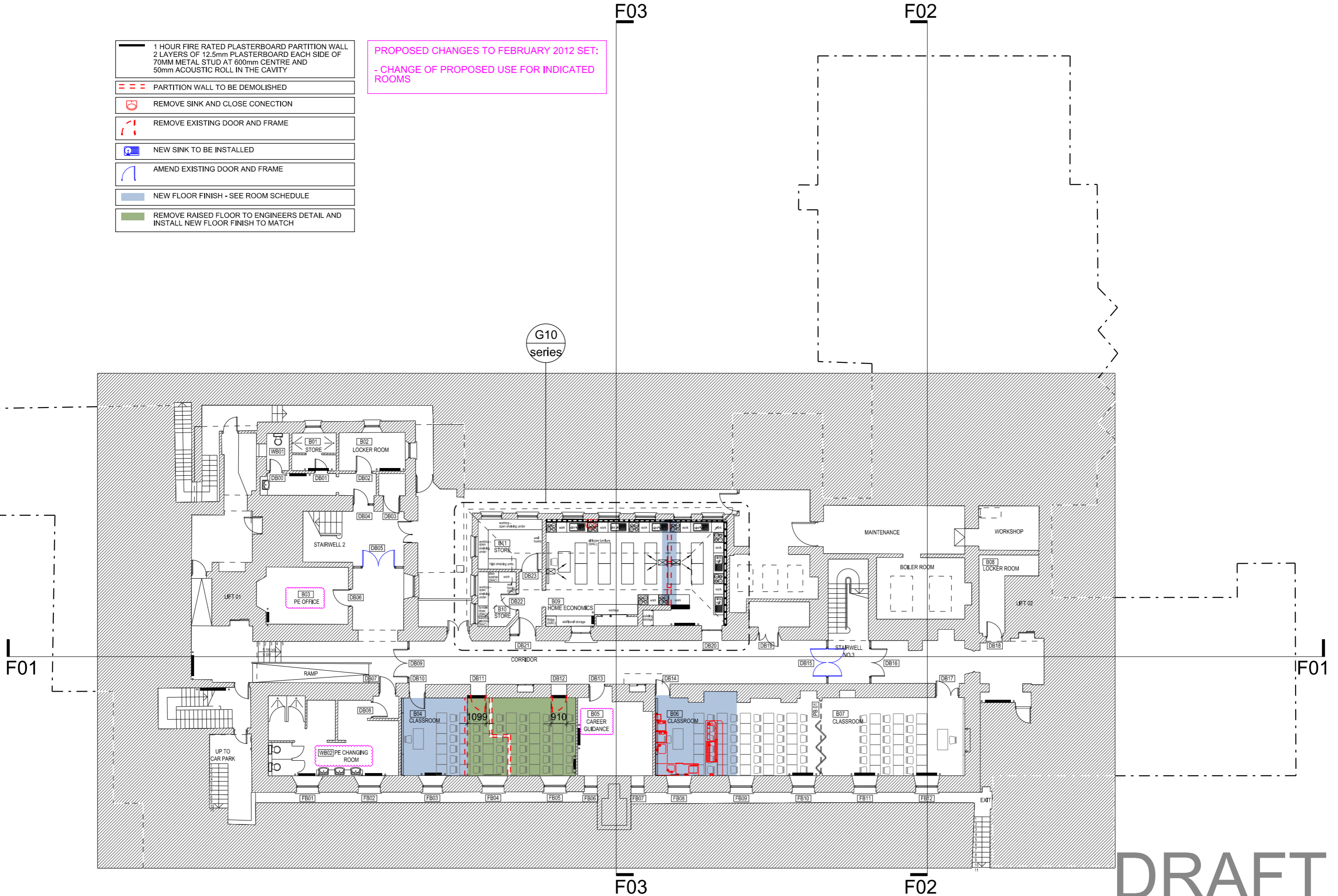

DRAFT

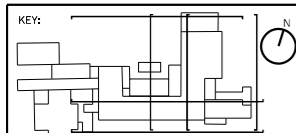

GENERAL NOTES:
USE FIGURED DIMENSIONS ONLY
DO NOT SCALE OFF DRAWINGS
CHECK ALL DIMENSIONS ON SITE
COPYRIGHT O'DONNELL + TUOMEY ARCHITECTS
DRAWING ISSUED FOR COMMENT AND COORDINATION
DO NOT BUILD OFF THIS DRAWING

NOTES:

REVISIONS:

O'DONNELL + TUOMEY
ARCHITECTS
20A Camden Row Dublin 8 Ireland
telephone +353 1 475 2500
facsimile +353 1 475 1479
email info@odonnell-tuomey.ie

PROJECT: A067
Marymount Hospice - St Angelas
Decant
STAGE: TENDER_VOLUME A.3.1
SCALE: 1:100 A1/ 1:200 A3
ISSUE DATE: 30.11.2012
DRAWN BY: HW

DRAWING TITLE: BASEMENT PROPOSED
DRAWING NO: D00
REV NO: -