

- 1 HOUR FIRE RATED PLASTERBOARD PARTITION WALL  
2 LAYERS OF 12.5mm PLASTERBOARD EACH SIDE OF  
70MM METAL STUD AT 600mm CENTRE AND  
50mm ACOUSTIC ROLL IN THE CAVITY
- PARTITION WALL TO BE DEMOLISHED
- REMOVE SINK AND CLOSE CONECTION
- REMOVE EXISTING DOOR AND FRAME
- NEW SINK TO BE INSTALLED
- AMEND EXISTING DOOR AND FRAME
- NEW FLOOR FINISH - SEE ROOM SCHEDULE

PROPOSED CHANGES TO FEBRUARY 2012 SET:

- CHANGE TEXTILE IN INTERMEDIATE LEVEL TO PE AND CHANGING AREA
- CHANGE PE HALL TO 2 x LABS PLUS PREPERATION AND CHEMICAL STORE
- REMOVE EXISTING PARTITIONS AND FLOOR COVERS
- INSTALL NEW PARTITIONS AND DOORS
- INSTALL NEW SERVICES
- NEW FLOOR COVERS
- INSTALL FOLDING PARTITIONS BETWEEN F06&F07 AND F08&F09
- AMENDED CLASSROOM LAYOUT IN F07 & F17
- CHANGE OF PROPOSED USE FOR INDICATED ROOMS

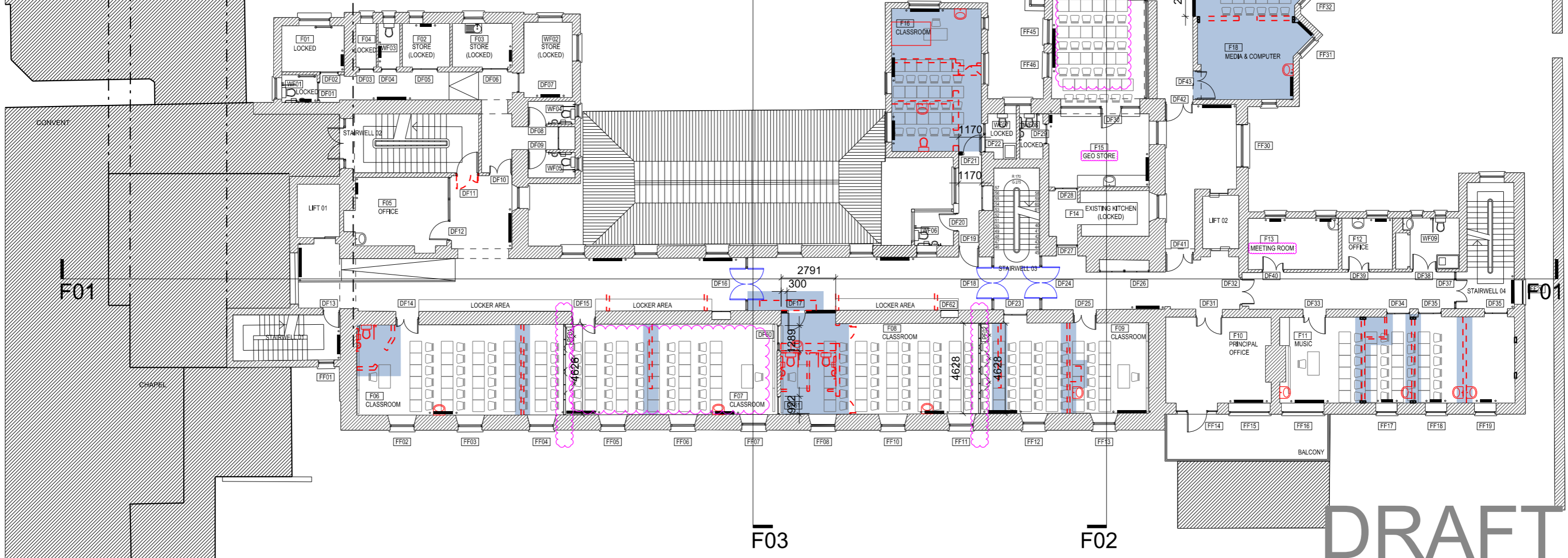

# DRAFT

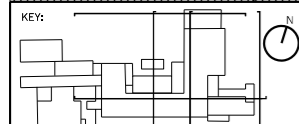

GENERAL NOTES:  
 USE FIGURED DIMENSIONS ONLY  
 DO NOT SCALE OFF DRAWINGS  
 CHECK ALL DIMENSIONS ON SITE  
 COPYRIGHT © O'DONNELL + TUOMEY ARCHITECTS  
 DRAWING ISSUED FOR COMMENT AND COORDINATION  
 DO NOT BUILD OFF THIS DRAWING

NOTES:

REVISIONS:

<p><b>O'DONNELL + TUOMEY ARCHITECTS</b></p> <p>20A Camden Row Dublin 8 Ireland          telephone +353 1 475 2500          facsimile +353 1 475 1479          email info@odonnell-tuomey.ie</p>	<p>PROJECT: A067  <b>Marymount Hospice - St Angelas Decant</b></p> <p>STAGE: TENDER_VOLUME A.3.1          SCALE: 1:100 A1/ 1:200 A3</p>	<p>ISSUE DATE: 30.11.2012          DRAWN BY: HW</p>	<p>DRAWING TITLE: <b>FIRST FLOOR PROPOSED</b></p> <p>DRAWING NO: <b>D03</b></p> <p>REV NO: -</p>
---	---	---	--