

	1 HOUR FIRE RATED PLASTERBOARD PARTITION WALL 2 LAYERS OF 12.5mm PLASTERBOARD EACH SIDE OF 70MM METAL STUD AT 600mm CENTRE AND 50mm ACOUSTIC ROLL IN THE CAVITY
	PARTITION WALL TO BE DEMOLISHED
	REMOVE SINK AND CLOSE CONNECTION
	REMOVE EXISTING DOOR AND FRAME
	NEW SINK TO BE INSTALLED
	AMEND EXISTING DOOR AND FRAME
	NEW FLOOR FINISH - SEE ROOM SCHEDULE
	- EXTEND STAIRWELL WALLS TO ROOF UNDERSIDE AND PROVIDE 60MIN FIRE RATED COMPARTMENT WALL - INCLUDING ACCESS DOORS/WALL PANEL IN ATTIC

PROPOSED CHANGES TO FEBRUARY 2012 SET:

- INSTALL FOLDING PARTITION BETWEEN S07 & S08 AND S05 & S06
- CHANGED CLASSROOM LAYOUT S05, 06, 07
- DEMOLITION OF WC'S AND INSTALLATION OF PARTITION AND DOOR TO CLASSROOMS
- CHANGE OF PROPOSED USE FOR INDICATED ROOMS
- PARTITION TO S15

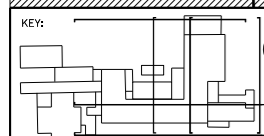
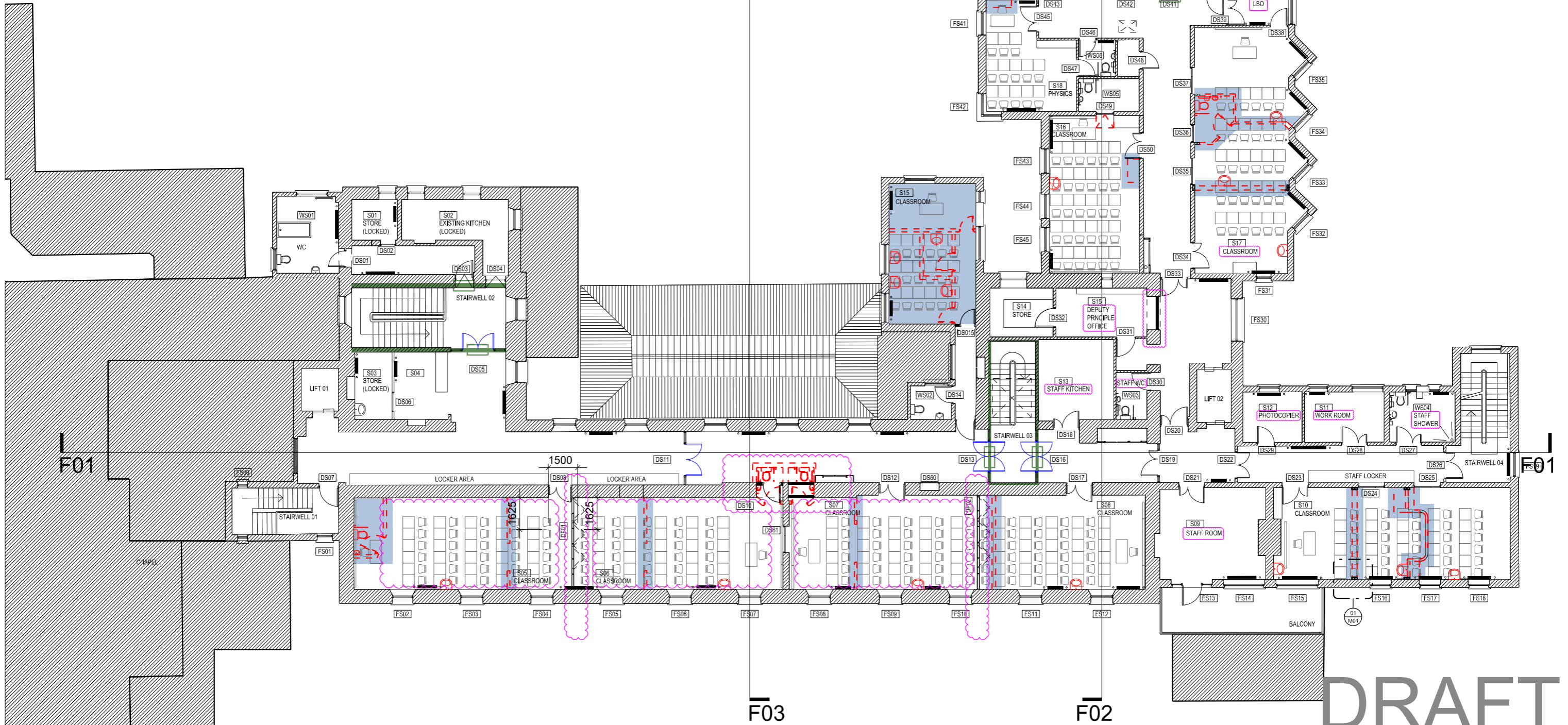

GENERAL NOTES:
USE FIGURED DIMENSIONS ONLY
DO NOT SCALE OFF DRAWINGS
CHECK ALL DIMENSIONS ON SITE
COPYRIGHT O'DONNELL + TUOMEY ARCHITECTS
DRAWING ISSUED FOR COMMENT AND COORDINATION
DO NOT BUILD OFF THIS DRAWING

NOTES:

REVISION:	DATE:	BY:

O'DONNELL + TUOMEY ARCHITECTS 20A Camden Row Dublin 8 Ireland telephone +353 1 475 2500 facsimile +353 1 475 1479 email info@odonnell-tuomey.ie	PROJECT: A067 Marymount Hospice - St Angelas Decant	DRAWING TITLE: SECOND FLOOR PROPOSED
	STAGE: TENDER-VOLUME A.3.1	ISSUE DATE: 30.11.2012
SCALE: 1:100 A1/ 1:200 A3	DRAWN BY: HW	REV NO: -